

Sherwood

SPLIT LEVEL UNIT

Main Floor

1 195 Square Feet

THE ESTATES VILLAGE

Sherwood Park, Alberta.

July 18, 1997

Dimensions Are Approximate .

Plan Subject To Some Change to Accommodate

Material Supply, Tender and Construction Requirements.

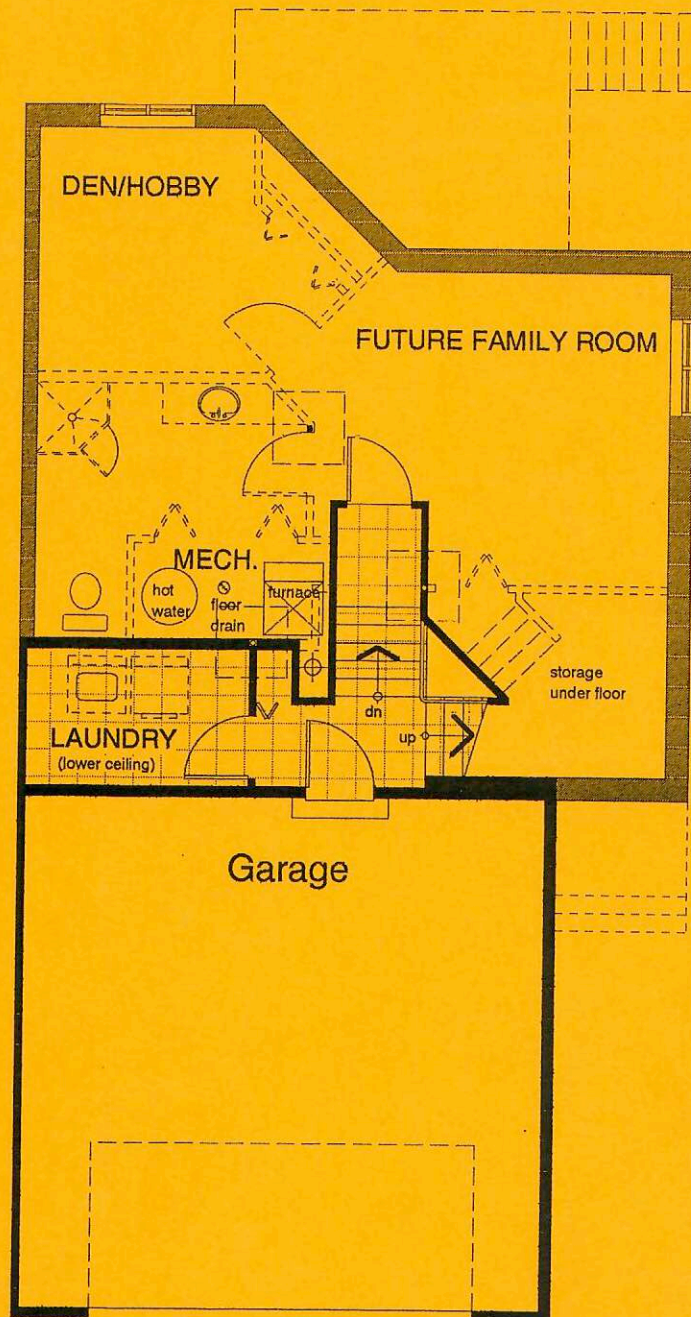

Sherwood

SPLIT LEVEL UNIT

Lower Floor

Developed (140 Sq. Ft.)

THE ESTATES VILLAGE
 Sherwood Park, Alberta.

July 18, 1997

Dimensions Are Approximate .

Plan Subject To Some Change to Accommodate
 Material Supply, Tender and Construction Requirements.